

HG 02 S/C Pješačka barijera



HG 02 S/C Specifikacije

Power Requirements	110/220-240V. 60/50Hz. AC (%±10) 24V.DC Single Unit: At standby ~10W. During operation ~39W. Center Unit: At standby ~20W. During operation ~78W
Dimensions	Single Unit : 1000 x 1020 x 300 + wing length (275) mm Center Unit : 1000 x 1020 x 300 + wing length (275 x 2) mm
Wing Features	RGB LED illuminated, 10 mm impact resistant tempered glass (opt. polycarbon) wings.
Top Lid	Tempered glass top lid (opt. other materials)
Body Features	The body is made of 304-grade (Opt. 316-grade) satin finished stainless steel.
Indicator & Display features	An illuminated acrylic layer under the glass top lid is included. At standby, the acrylic layer illuminated in blue; during authorised passages it flashes green; when an unauthorized attempt is detected or during alert mode it flashes red. (opt. sliding asteroid animated indicator on top lid)
Operating Temperature, Humidity, IP Rating, MCBF	-20°C to +68°C RH 95% non-condensing / IP 44 Indoor Model/ 1M Cycles
Control System	All inputs are opto-coupler protected .Controlled by dry contact or grounding input. Compatible with all access control systems that provide dry contact or grounding outputs. Optional RS232/RS485/TCP IP control module is available.
System Features & Operation	Normally Closed Position: The wings are closed crossing the lane at standby. Wings open rapidly to allow passage when input is received by either direction. Internal dip switch selectable free passage by photocell detection, restricted access, controlled access on both or single direction modes are built in features.
Output Data	The system provides dry contact passage feedback by relays.
Emergency Mode	System allows free passage in emergency mode and in case of power failure (powered by internal back-up battery).
Flow Rate	Wing opening speed/time: 0,5 sec. wing closing speed/time: 0,5 sec. Nominal: ~30 - 60 passages/minute (recommended reference figure). Utilisation of different access control units can change the flow rate.
Standard Features	RGB LED illuminated status indicators, tempered glass top lid.
Optional Accessories and Applications	Sliding asteroid animated indicator on top lid, remote control unit, manual control, coin slot/intelligent coin system and coin box, counter, card reader pole, photocell alarm sensor, interface unit for PC, RS485, RS232 and LAN, audio-messaging system, base plate, separator.
Note	A passage lane consists of min. 2 pieces of single units facing each other.

HG 02 S/C Specifikacije

Single – sided

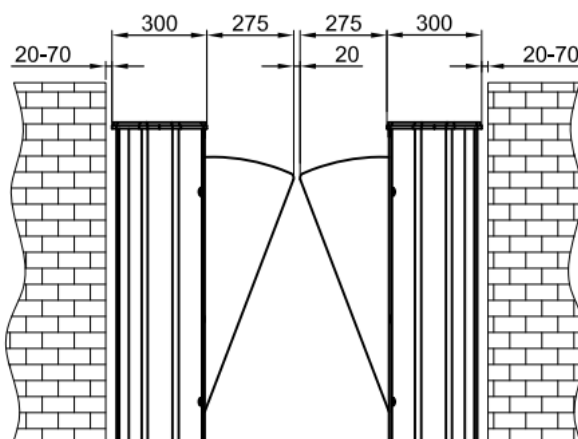
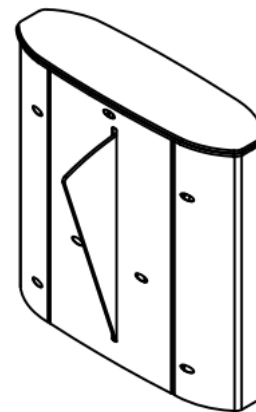
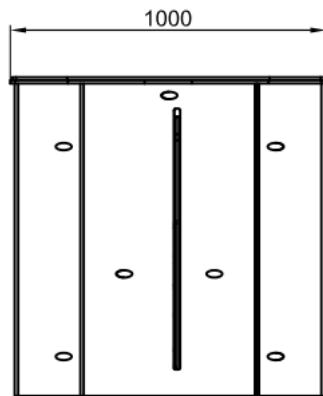
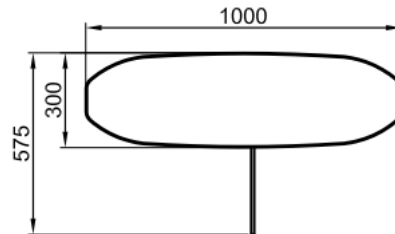
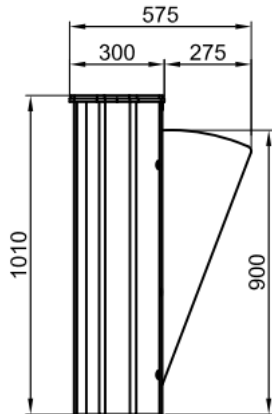

HG 02 S Tehnički nacrt

Central unit

